

TOWNSHIP OF MADAWASKA VALLEY ZONING BY-LAW
 SCHEDULE "A" (Map 4)
 (North Half of the Geographic Township of Sherwood)

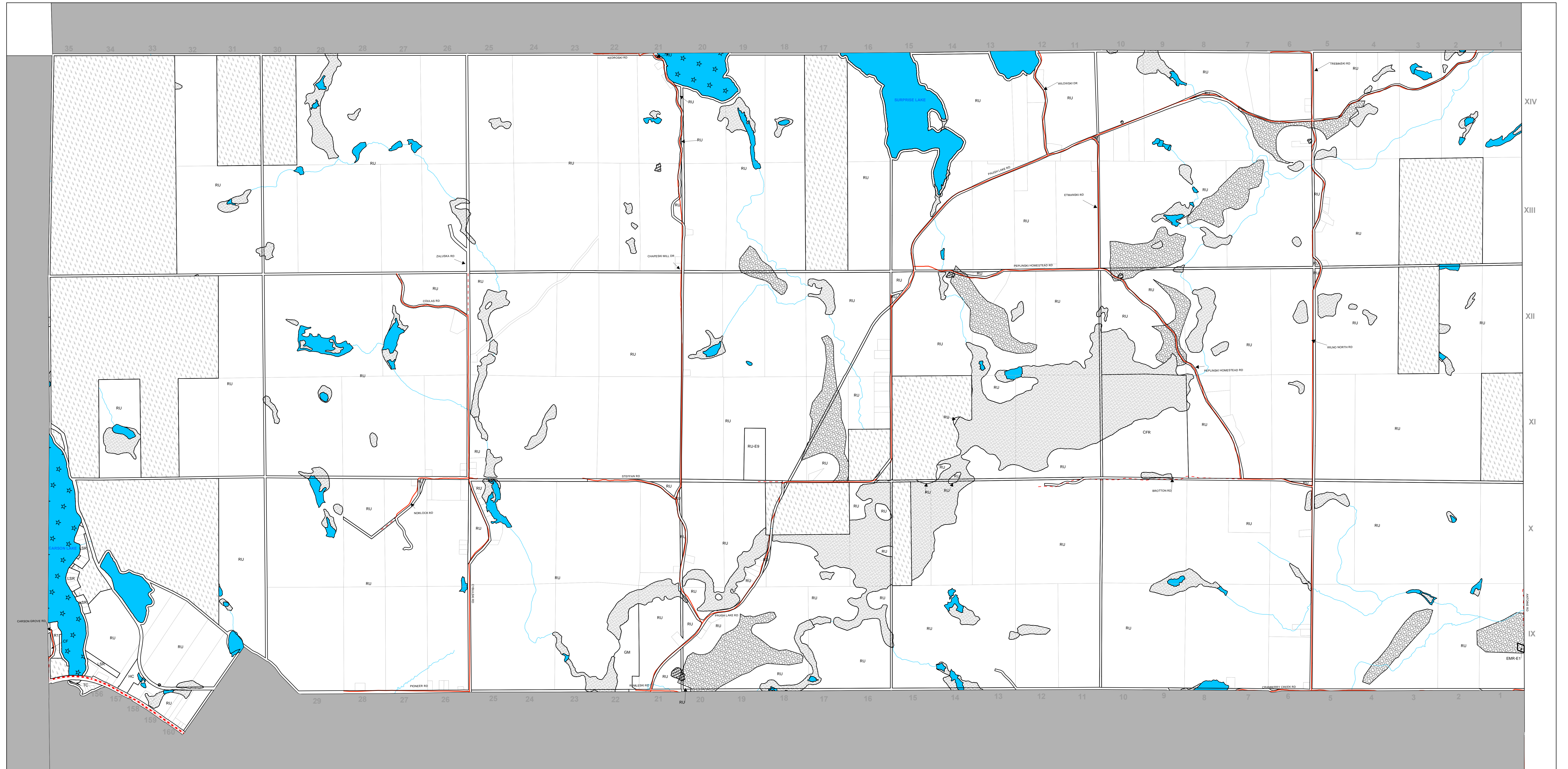

- R1** Residential One
- R2** Residential Two
- LSR** Limited Service Residential
- SR** Seasonal Residential
- C** Commercial
- HC** Highway Commercial
- TC** Tourism Commercial
- GM** General Industrial
- DM1** Disposal Industrial One
- DM2** Disposal Industrial Two
- RU** Rural
- CF** Community Facility
- OS** Open Space
- SUR** Suburban Reserve
- h** Holding Zone

- E1** Exception One (Numbered consecutively for each respective zone classification e.g. RU-E1, RU-E2, etc.)
- CFR** County Forest
- Crown
- Flooded Area
- Environmental Protection (EP)
- Extractive Industrial (EM)
- Extractive Industrial Reserve (EMR)
- Provincially Significant Wetlands (PSW)
- Areas of Natural and Scientific Interest (ANSI)
- Open Water
- Sensitive Lake
- Active Waste Disposal Site on Crown Land
- Inactive Waste Disposal Site
- Water Course
- County Road
- Provincial Road
- Municipal Maintained Year-Round Road
- Municipal Seasonally Maintained

This is Schedule "A" to By-Law No. 2006-26
 Passed the 1st day of MAY, 2006.

Signatures of the Signing Officers:

[Signature] Reeve
[Signature] CAO/Clerk

[Signature]
 ACTING CHAIRPERSON

Map Consolidation Date
 Housekeeping Bylaw Consolidation - May 2, 2011
 January 18, 2010

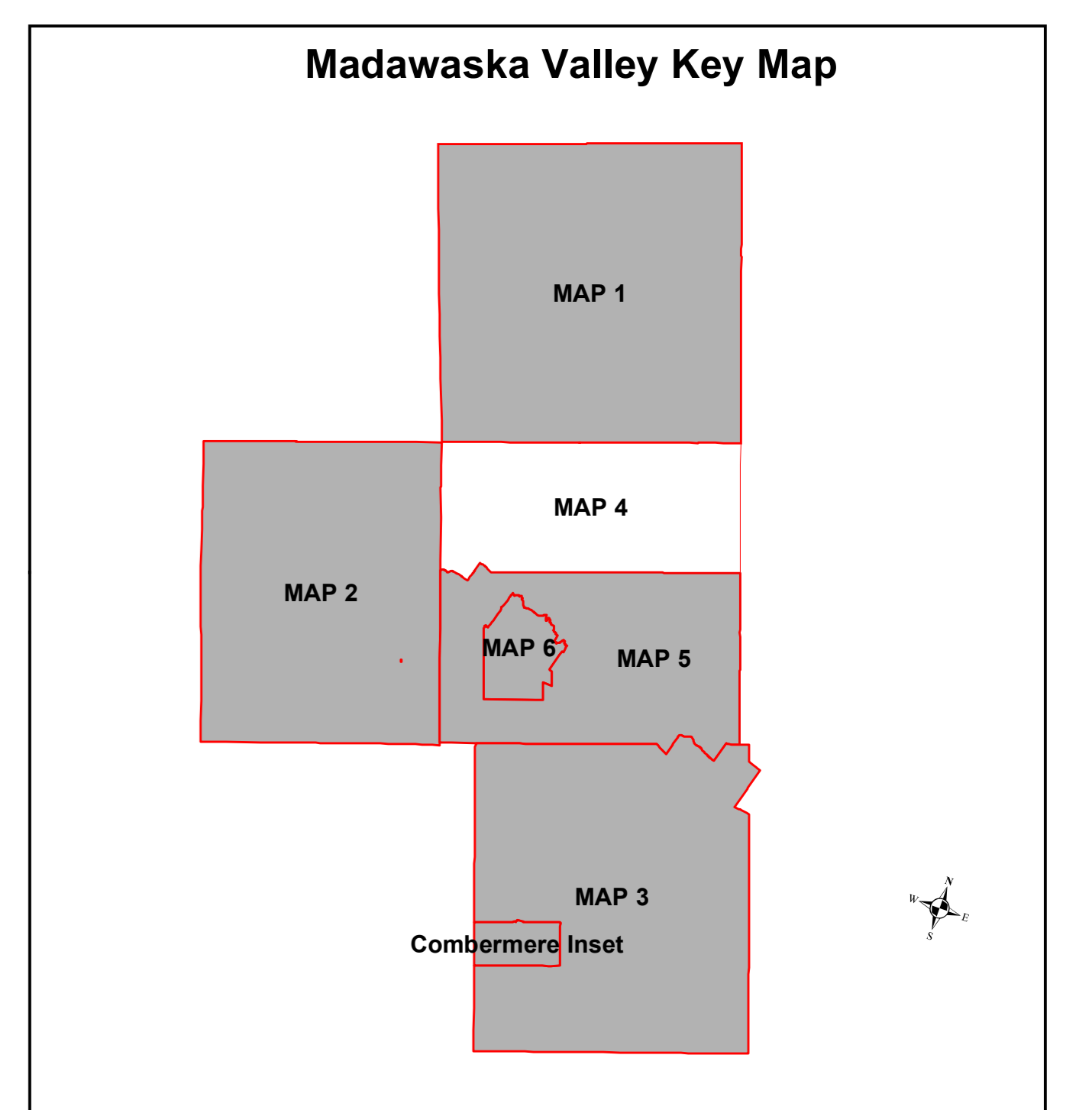
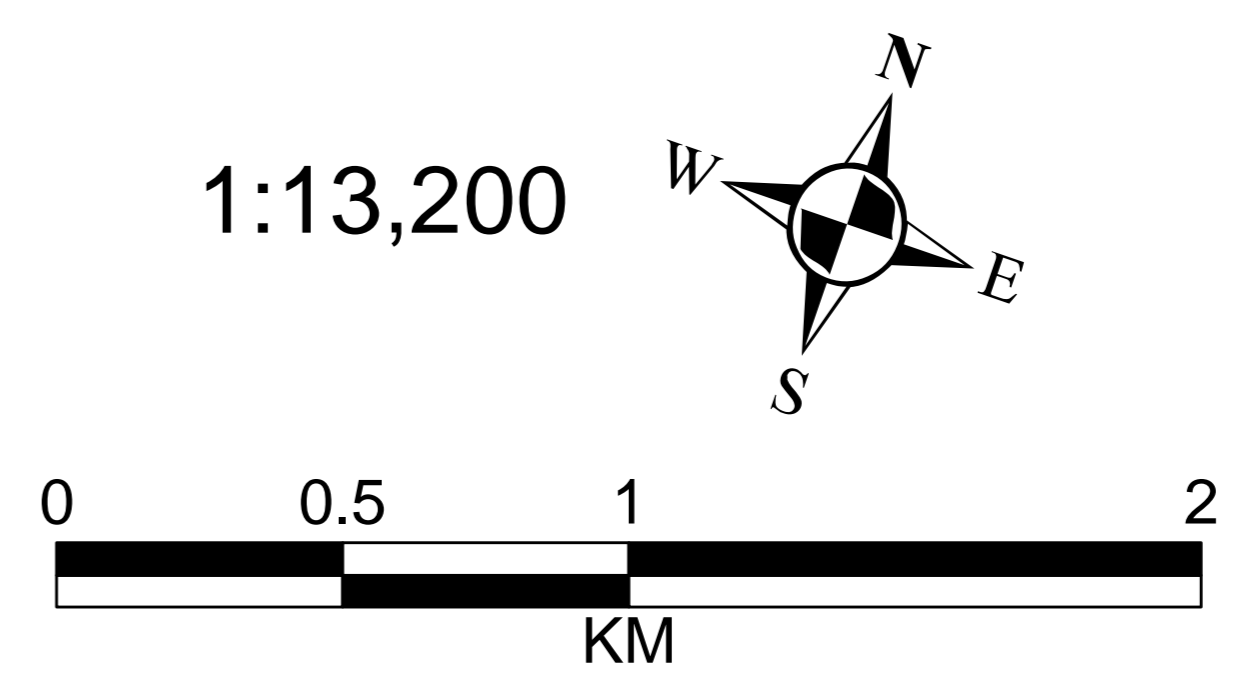

Produced by the County of Renfrew Development and Property Department under licence with the Ontario Ministry of Natural Resources © 2006, Queen's Printer for Ontario. This map is illustrative only. Do not rely on it as being a precise indicator of routes, locations of features, nor as a guide to navigation.